

Contractors are not to scale
dimensions from this drawing

Revision Date

A	- Column references added	
B	Additional column references added and additional SHS's added to stair pool	05/06/00 SF
C	Core position amended, stair section line#4, 07/00 DC	
D	removed, lift openings amended as dwg 322.	
E	Stair core setting out dim. revised	17/07/00 MDW
F	Section ref B-307 hatched	27/07/00 RBB
G	Section ref C - H inc and window refs added	02/08/00 SF
H	Movement joints & slip lines added, stringer/door opening sizes amended to core doors.	17/07/00 DC
I	Fenestration dimensions amended 30mm	14/04/00 RBB
J	Grid 'C' dimensions substituted to suit	
K	Window detail on grid 6 revised & WS19/10/00 SF	
L	Door refs revised	01/11/00 SF
M	Door ref's revised	
N	Curtain walling & ribbon glazing updated	08/01/01 DC
O	Dim grid 1-A revised to 440mm	09/01/01 DC

NOTE:
F.F.L. refers to top of raised access floor

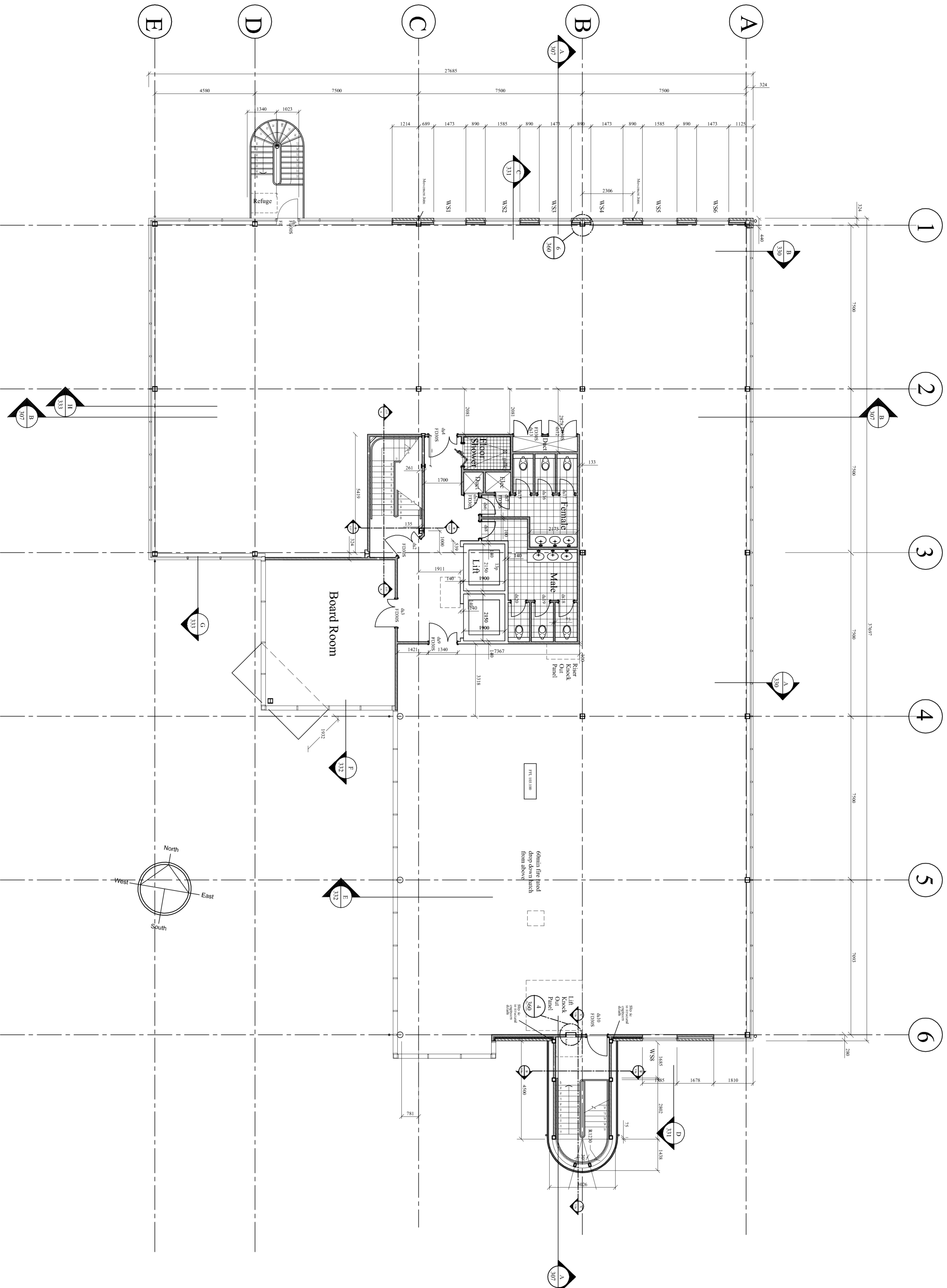

Ballast Wiltshier
Ballast Wiltshier Plc (South West Region)
Telephone: 01282 240001 Fax: 01282 260024

BroadwayMalvan
Architects & Designers

8 Southampton Street
Southampton, Hants, SO15 2ED
T: +44(0)2390 248000
F: +44(0)2390 330986
E: so1@broadwaymalvan.com

Client
Lamron Estates
Developments Ltd
Project
Renaissance
Basing View, Basingstoke
Description
Building C
Second Floor Plan

Status

For Construction

Scale	Drawn	Date
1:100	RV	23 May 200
Job number	Drawing number	Revision
8624	302	M

Original size 100mm Copyright Broadway Malvan Limited